



DESIGN HIGHLIGHTS

- Push Up Lid
- Full cable management
- Compact design for minimum spatial requirements
- Only 55mm of height above television required
- Near silent motor system

OPTIONS

- Bang & Olufsen / Loewe mount option
- B&O Beo4 control option

Suitable for mounting the
slimmest screens available
due to the slim base plate

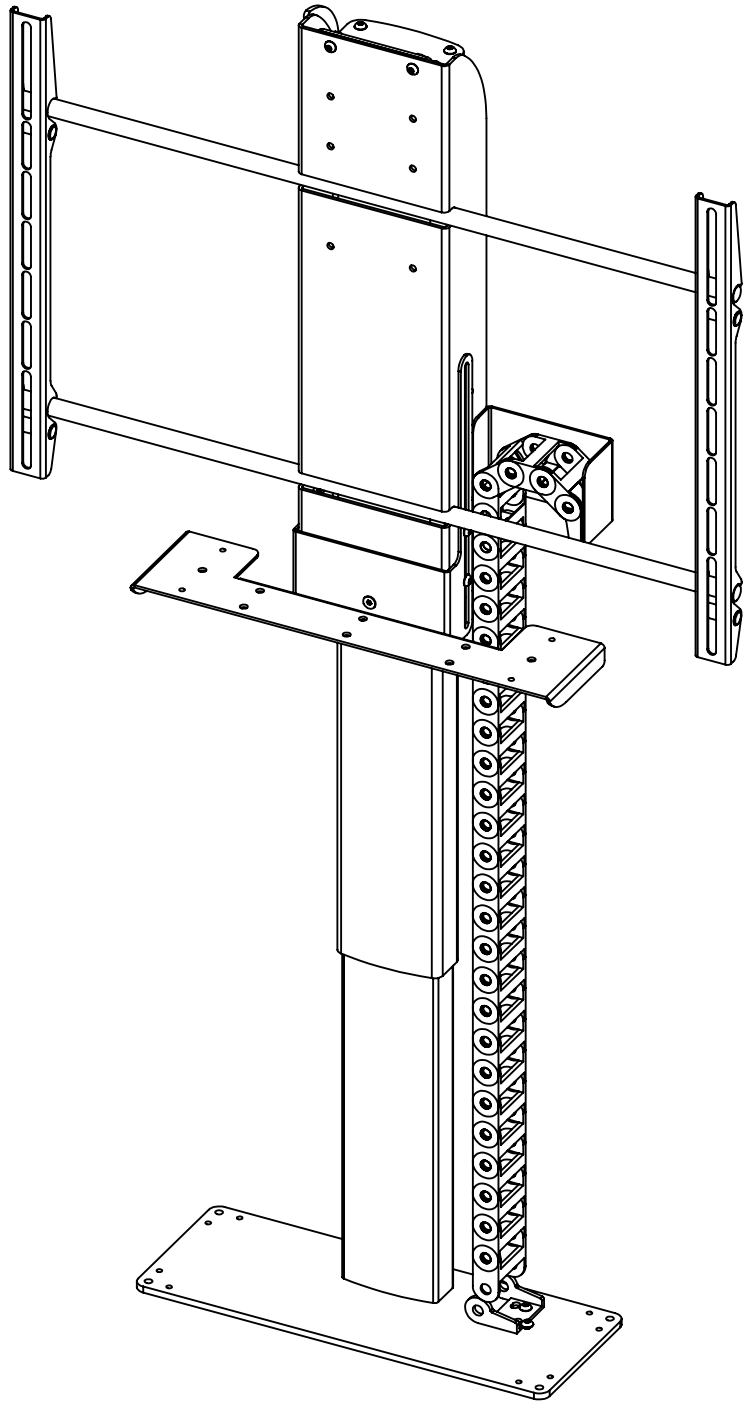

CLOSED

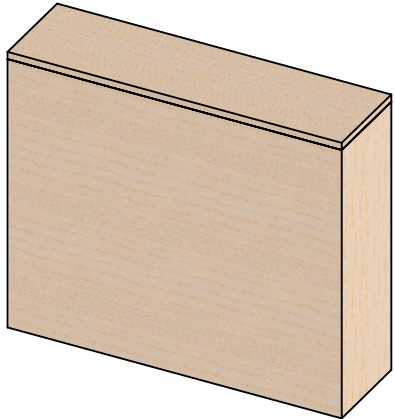

OPEN

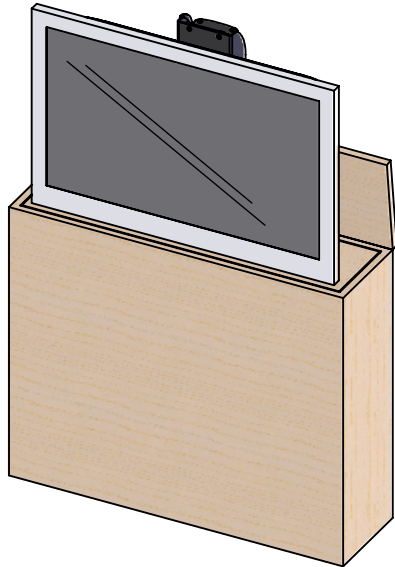

FUNCTION

A lifting mechanism which
raises a screen from within a
cabinet up into a viewing
position.

An adjustable push rod acts
on a hinged cabinet flap
panel. The flap is pushed up
when screen is raised. Once
the screen is lowered the
panel will fall back to the
closed position.

SUITABILITY

The AL675 is the smallest
actuator lift mechanism
which is suitable for
screens 26" - 42".

Other mechanism are
available such as the
AL820 and AL965.

SPECIFYING

Check screen details for
mounting possibilities.

Max screen height 645mm [25.4"]

Check cabinet and hinged lid
details.

CONTROL

Supplied with basic
infrared remote. Can be
learnt by many learning
remotes.

Also has switch control
and can be operated by
relays, switches, Crestron
/ AMX or Lutron systems.

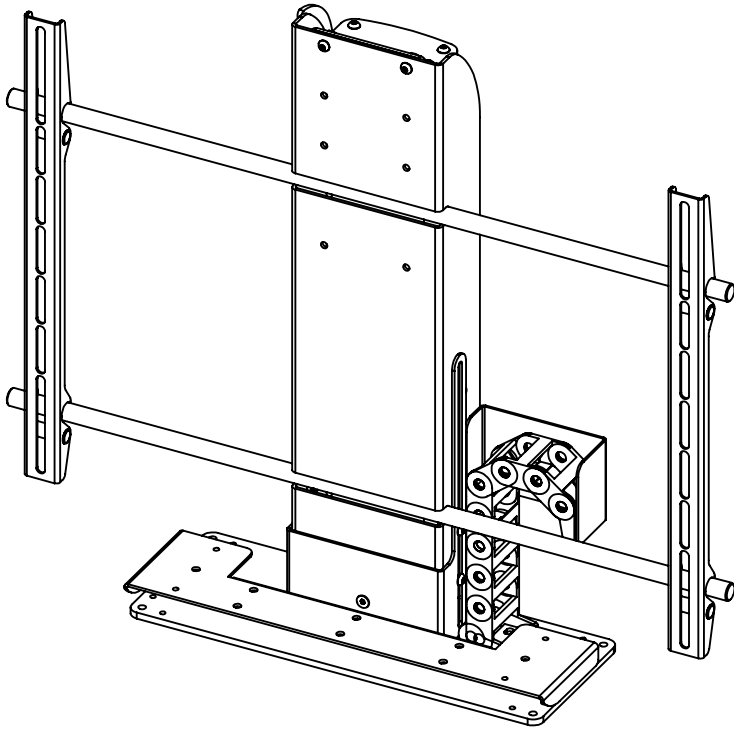

Smooth, whisper quiet,
screen lifting mechanism
with 675mm of travel

WARNING

It is the responsibility of
the installer to warn all
potential end users of
the dangers of interfering
with mechanisms during
operation

IMPORTANT

Mechanisms which lift
or move weights need
to be checked on a
yearly basis for any
damage which may
result in an accident

Dimensions shown are for AL675 Cabinet

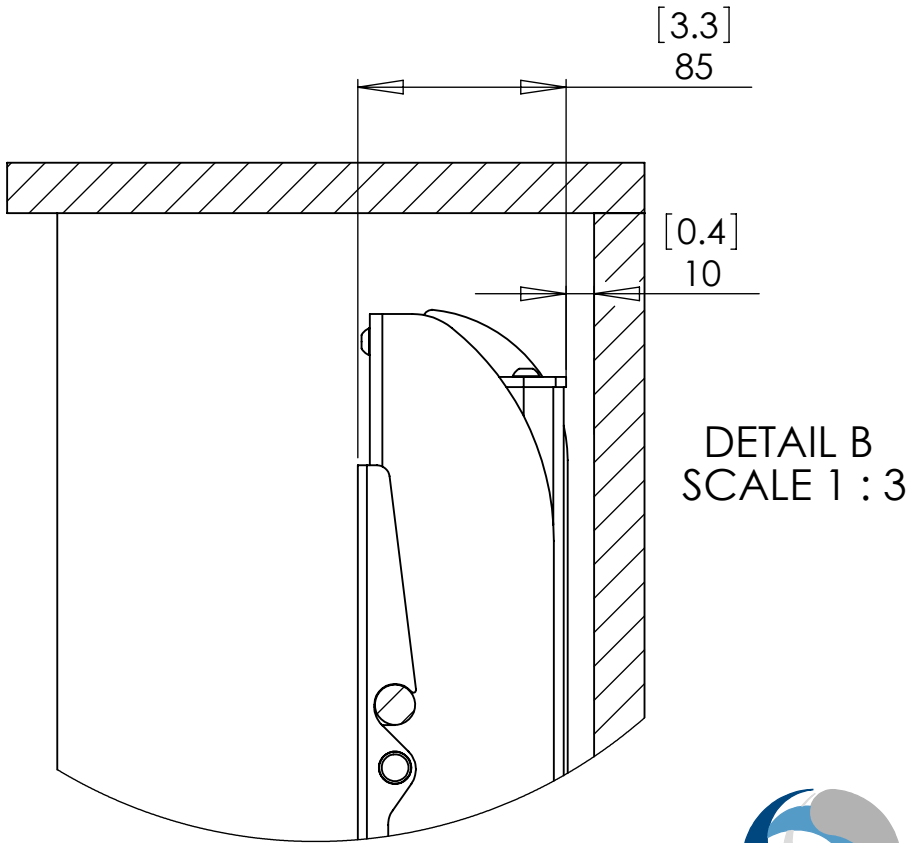
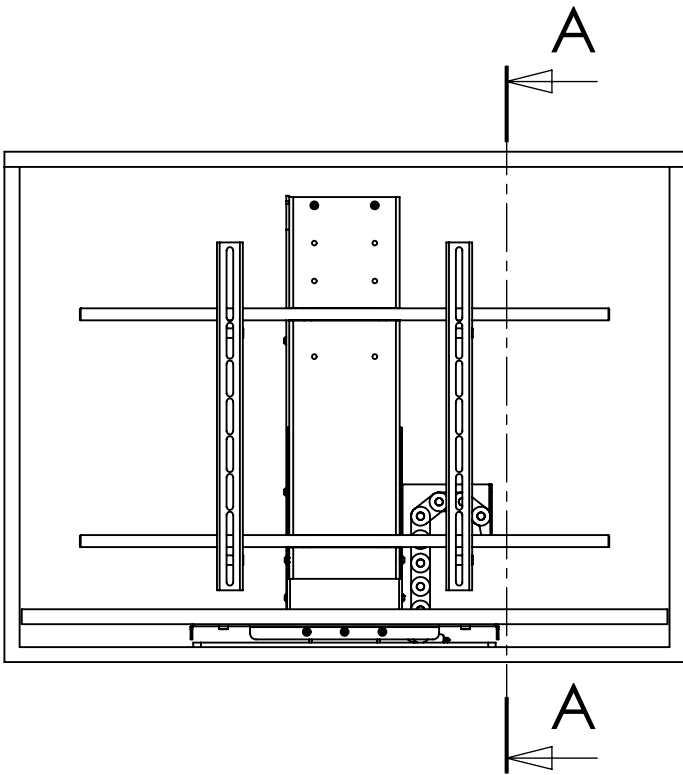
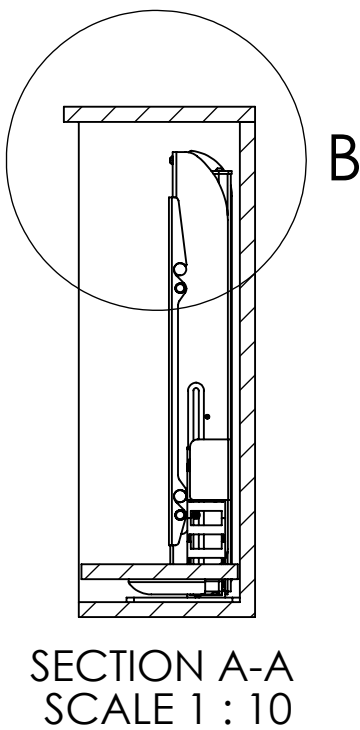
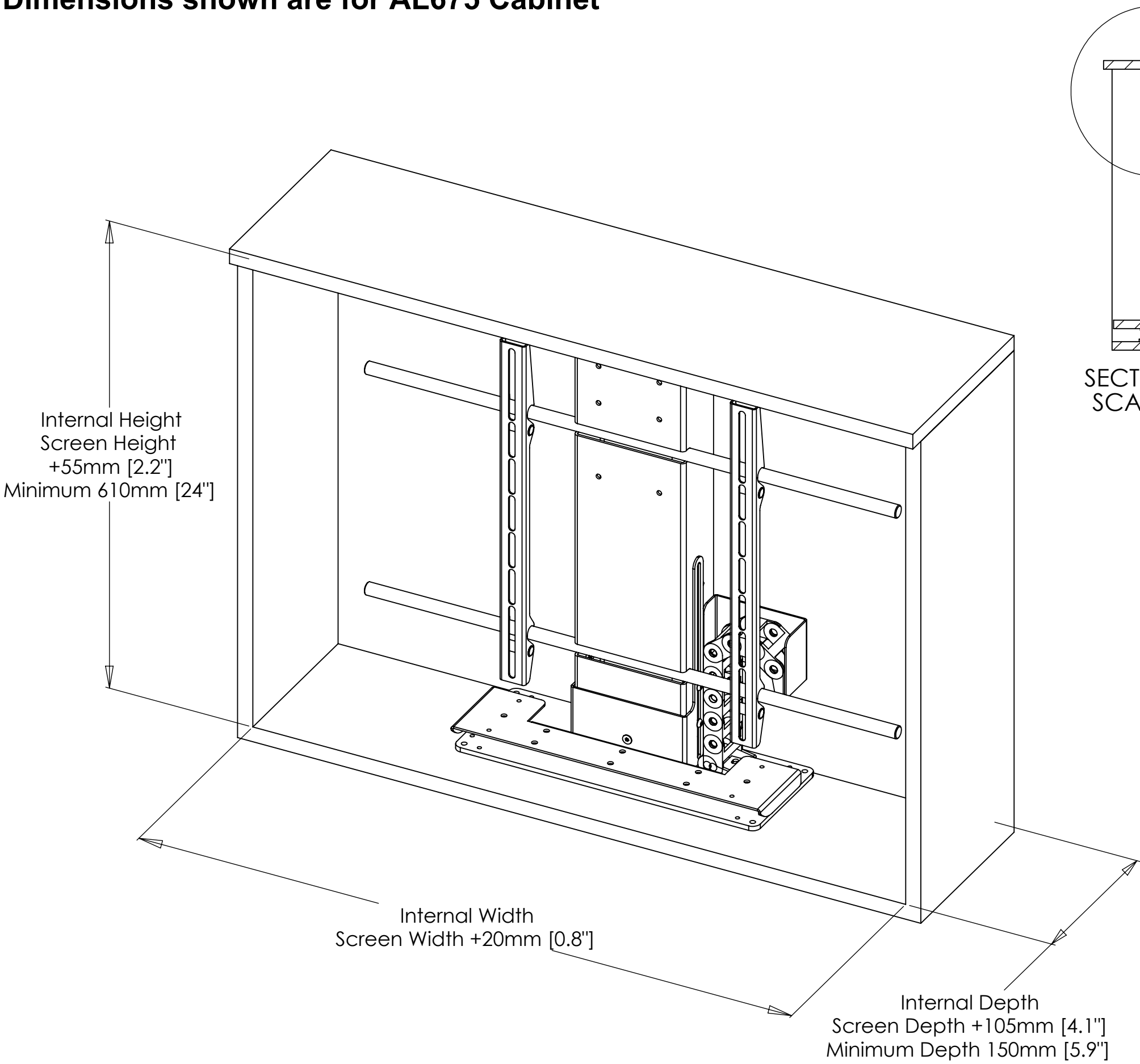

AL675 Base Dimensions

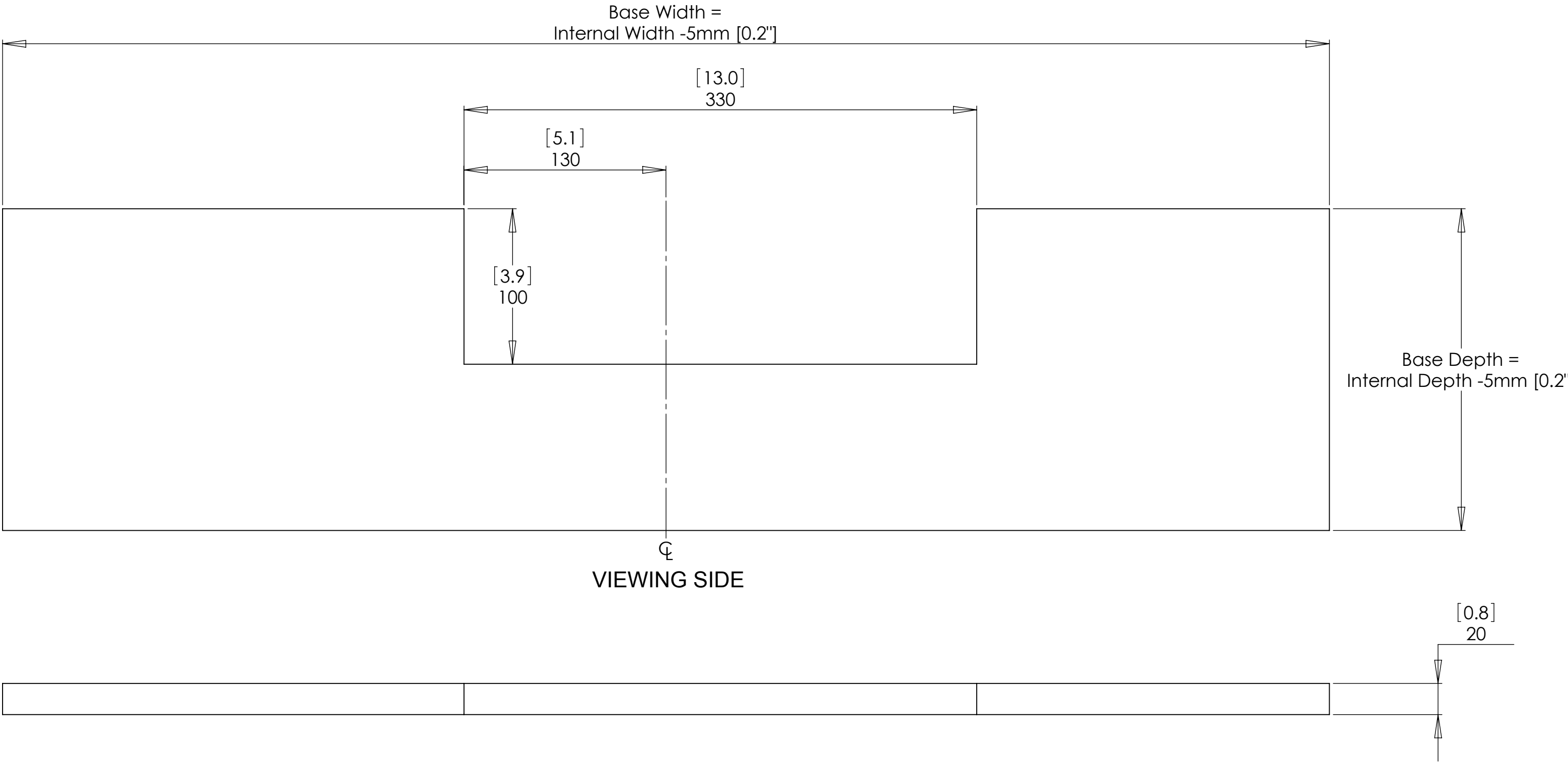

Starting Position Adjustment

The starting position of the screen can be adjusted.
From the lowest possible setting, the starting position
can be adjusted by 50mm [2"], 100mm [4"] or 200mm [7.9"].

The mechanism will then travel 675mm [26.6"]
up from this starting height.

This can be useful when mounting larger screens or
when using an existing cabinet.

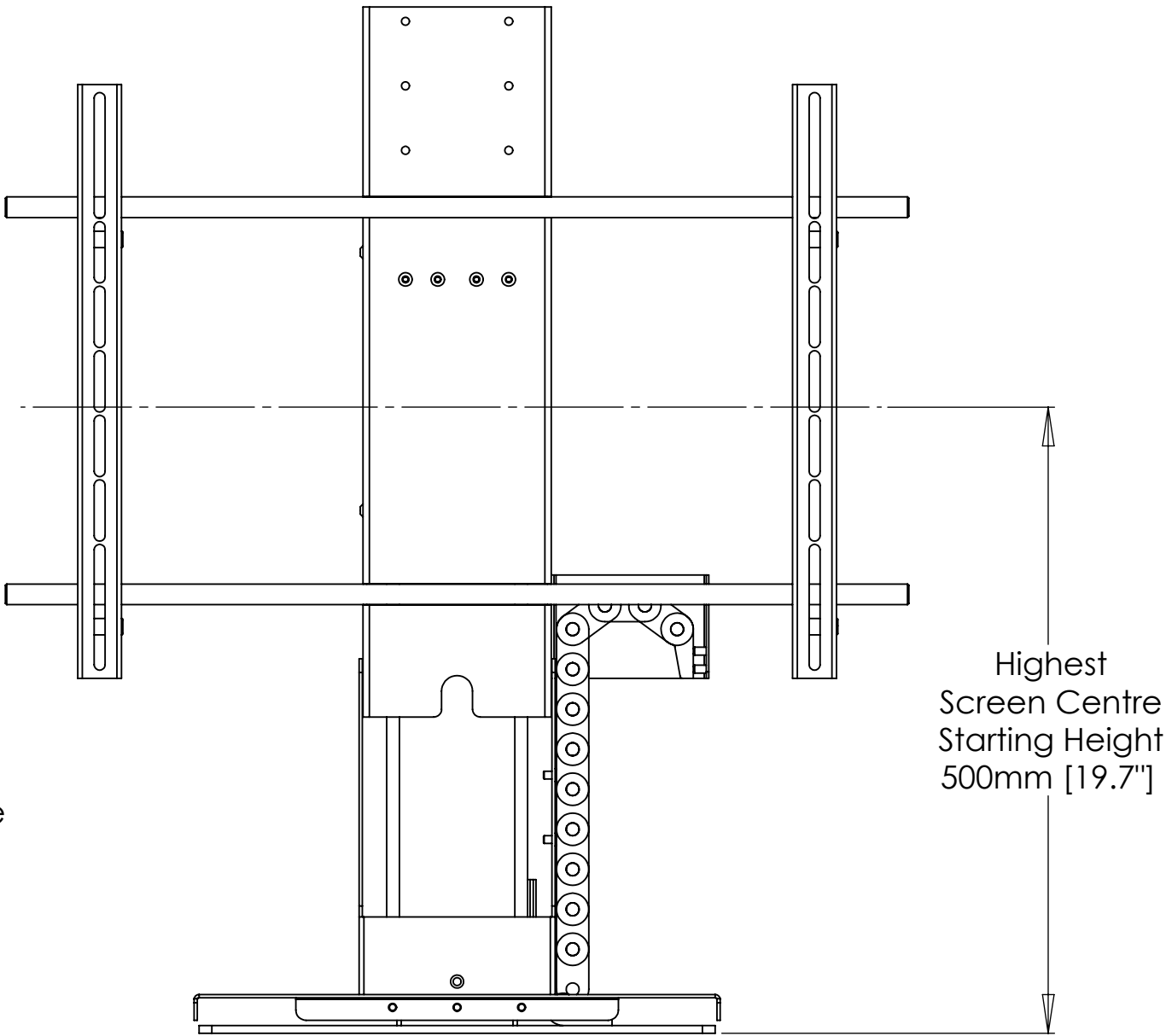
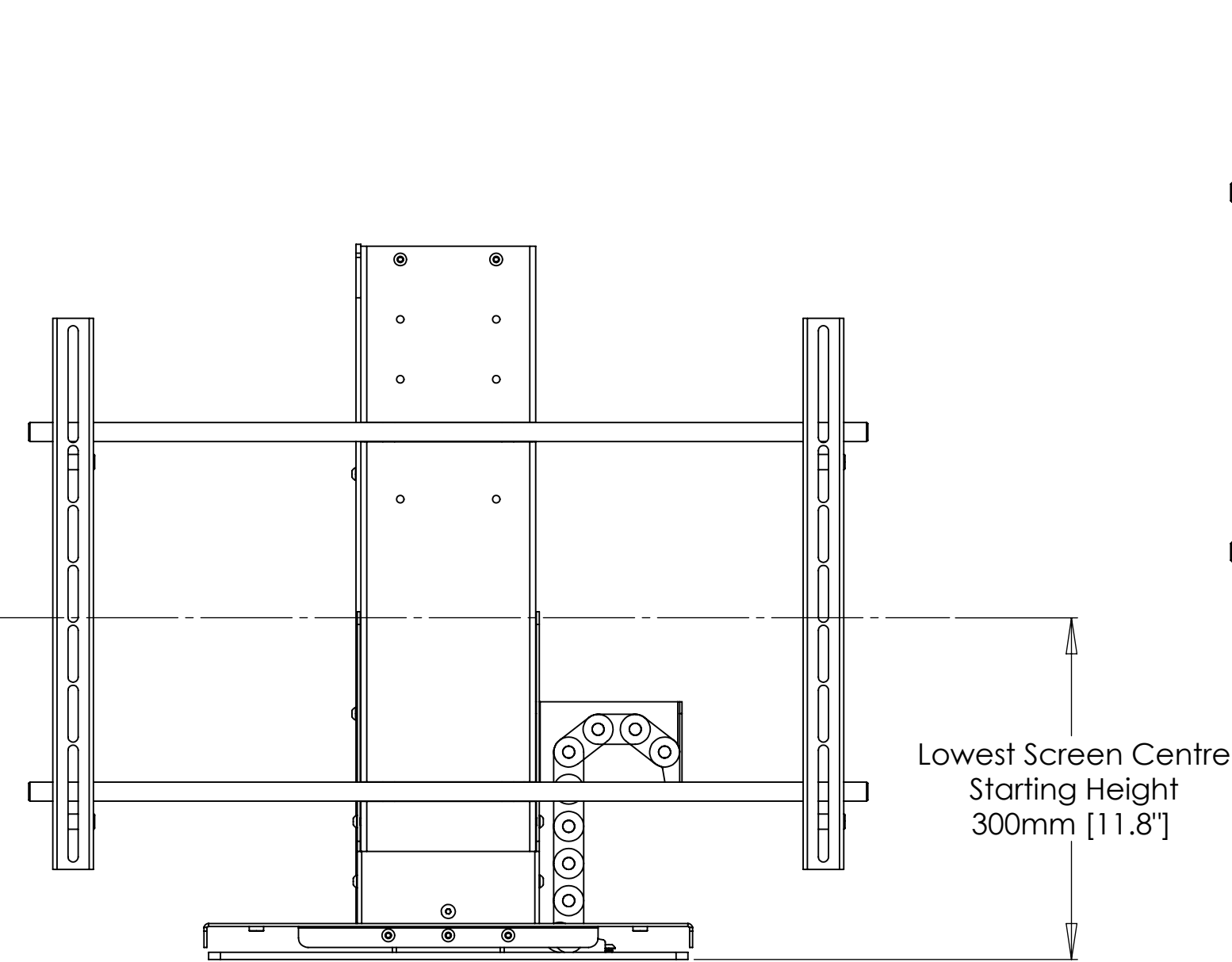

Starting Position Adjustment

The starting position of the screen can be adjusted.

The mechanism will then travel 675mm [26.6"] up from this starting height.

This can be useful when mounting larger screens or when using an existing cabinet.

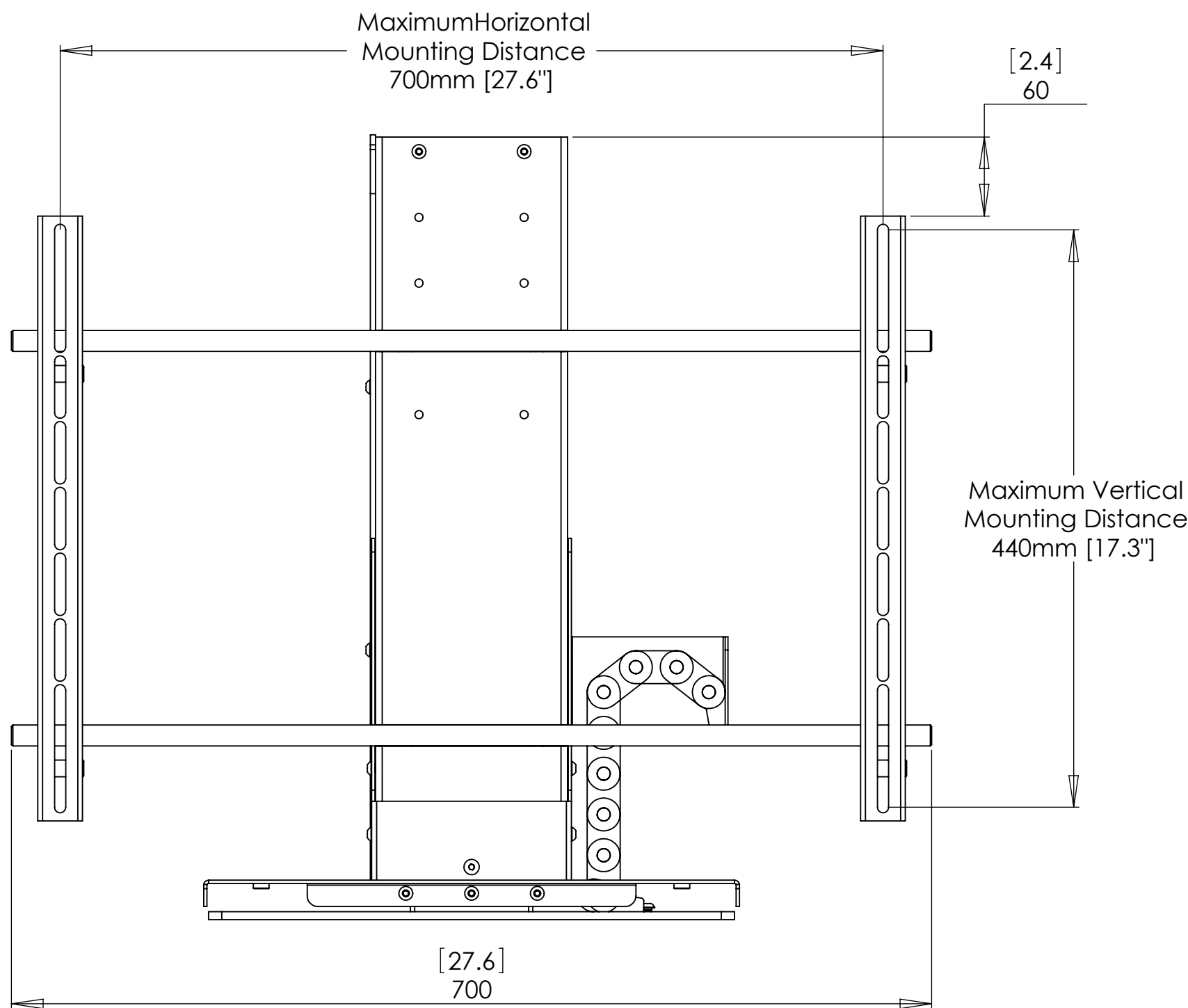

Shown in Down Position

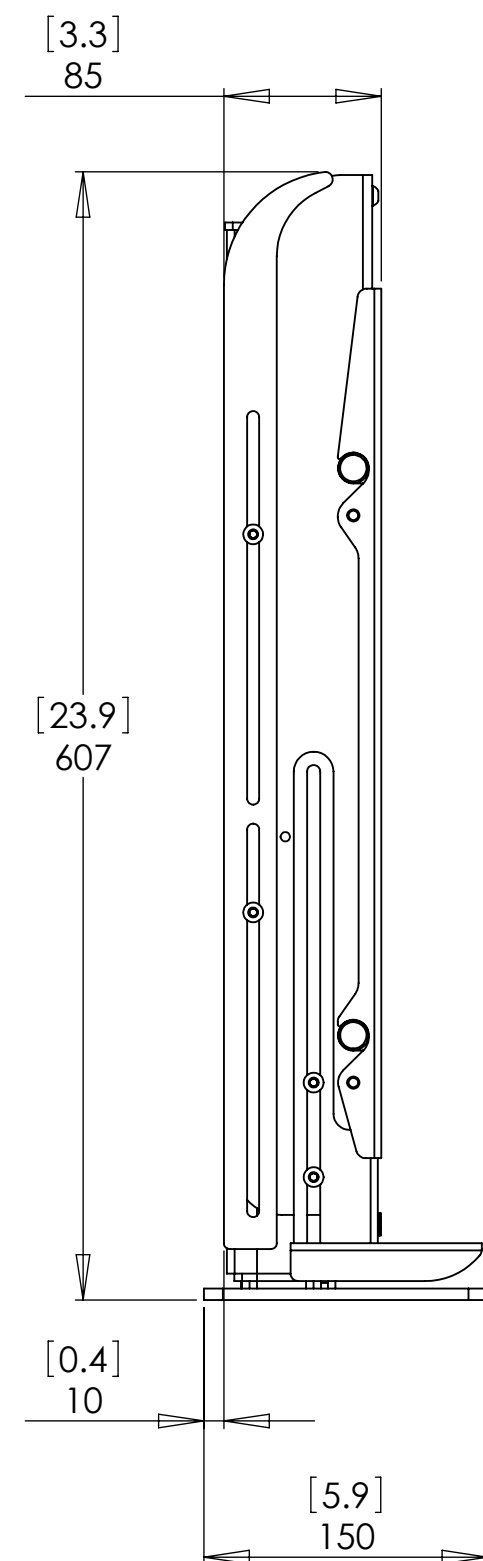

AL675 Mechanism Dimensions

Shown in Up Position

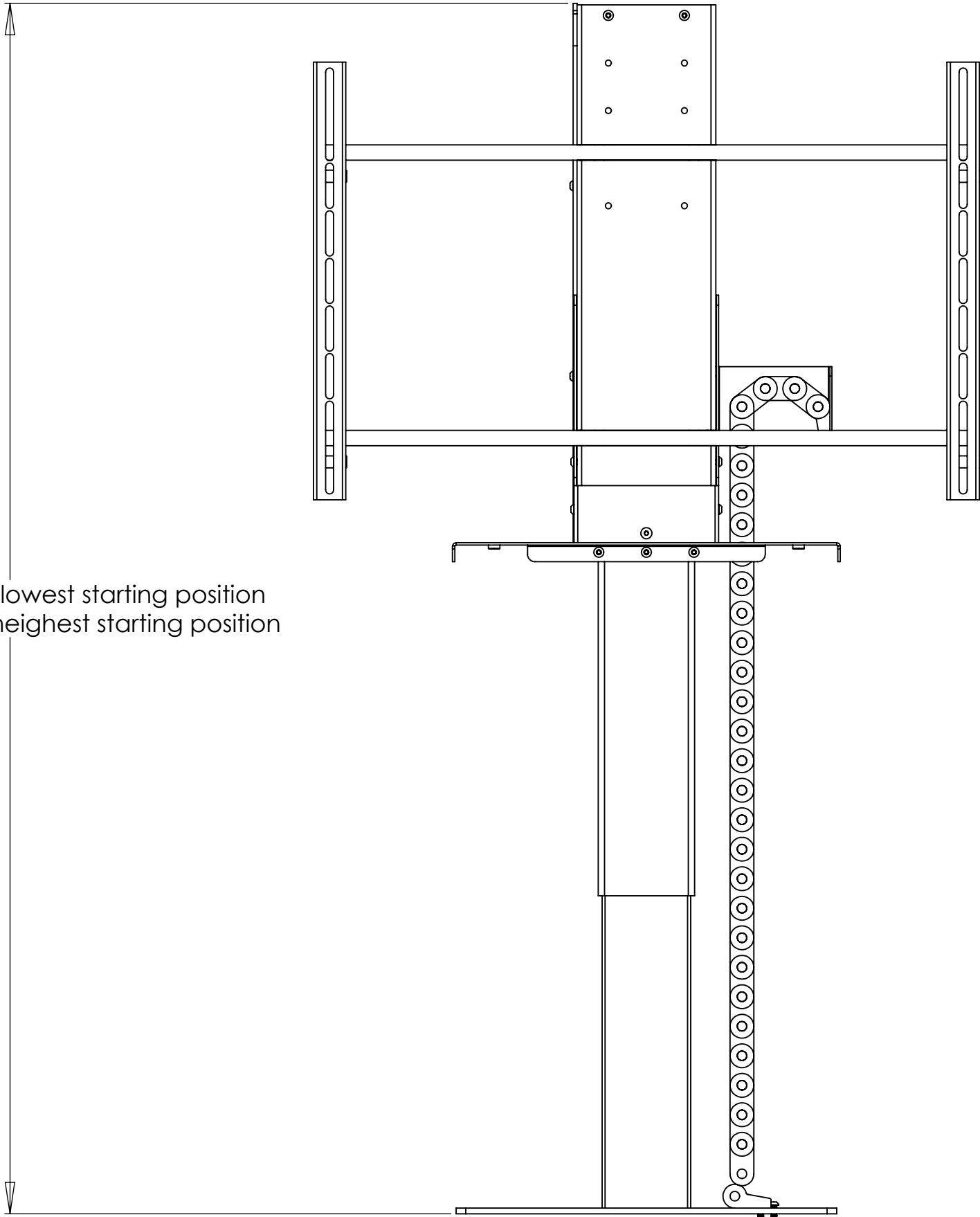

1275mm [50.2"] from lowest starting position
1475mm [58.1"] from highest starting position

