

# CHRST7-RES

## RESIDENTIAL CEILING HINGE RANGE WITH SWIVEL AND TELESCOPE

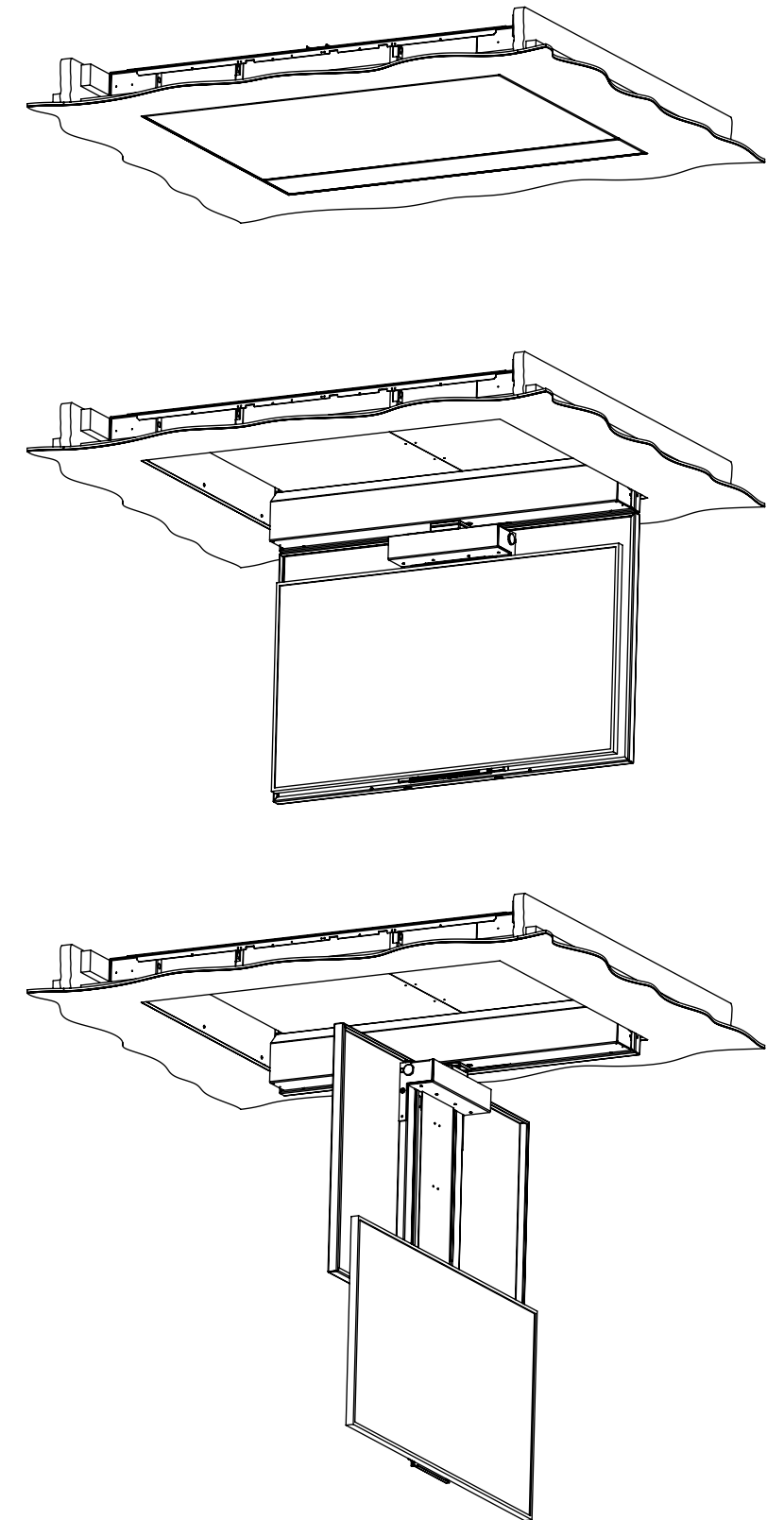
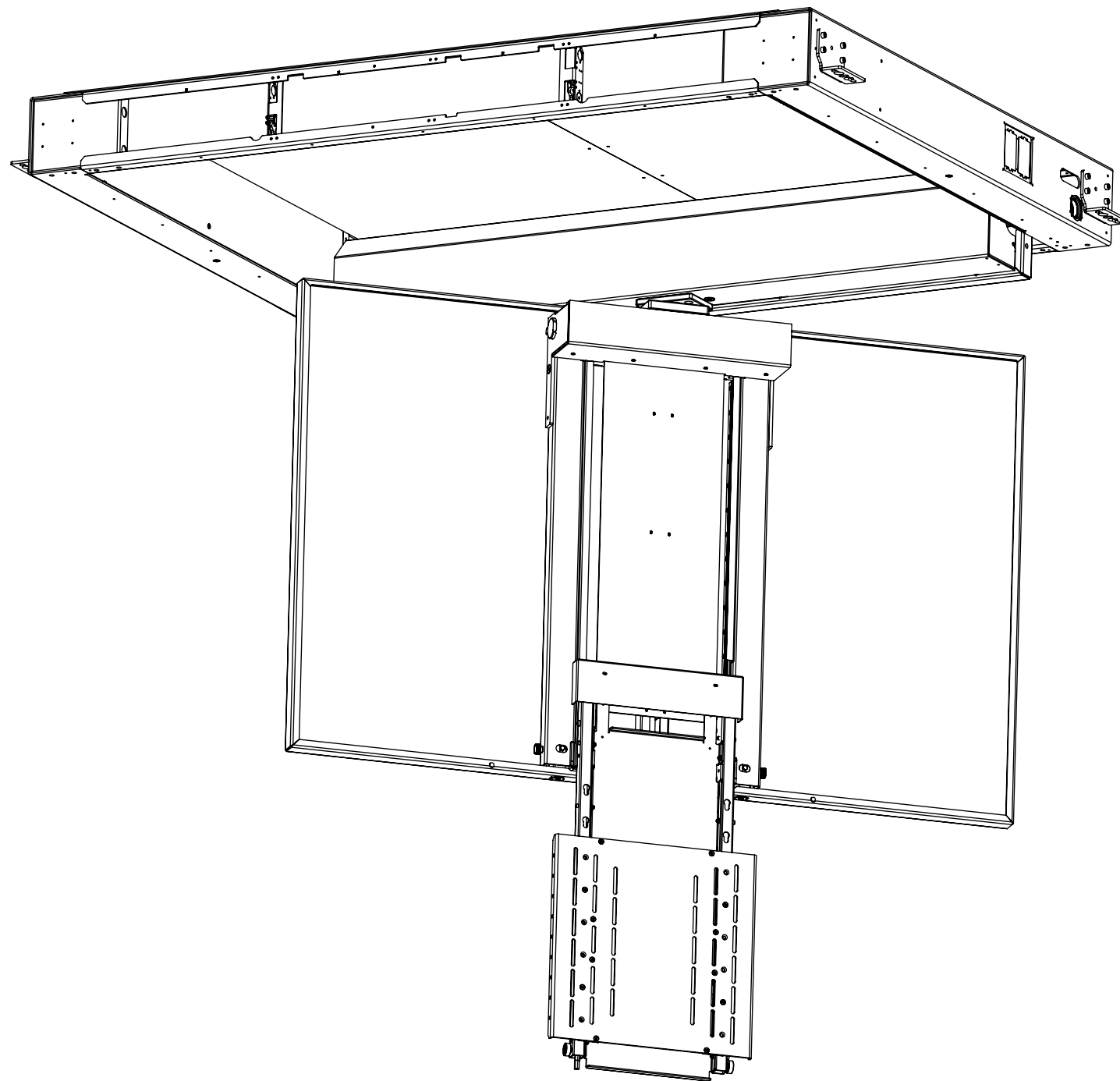

# CHRST7-RES

## RESIDENTIAL CEILING HINGE RANGE

### WITH SWIVEL AND TELESCOPE

SPECIFICATION	MEASUREMENTS
Product Dimensions	2224mm [87 9/16"] W x 1545mm [60 13/16"] L x 220mm [8 11/16"] D
Product Weight	230Kg [507lb]
Maximum Screen Size	1730mm [68 2/16"] W x 970mm [38 3/16"] L x 100mm [3 15/16"] D
Maximum Weight Capacity	50Kg [110lb] Max. <i>*Assuming Screen Weight Biased Low (3/4 Screen Height)</i>
Packaging Dimensions	2260mm [89"] W x 1720mm [67 11/16"] L x 440mm [17 5/16"] D
Shipping Weight	325Kg [717lb]
Maximum Rotation	90 ° on Hinge, 180° CW and CCW on Swivel
Movement Type	Motorised
Control System	Housed Internally - Accessible by Internal Access Hatch
Power Supply Required	110V - 240V AC 50/60Hz
Power Consumption Max.	720W
Power Consumption Standby	3W
Mounting Patterns Supported	VESA 400, 300, 200 W x 400, 300, 200 H
Control Options	IR Remote, RS232, Contact Closure
Product Options / Features	Specific B&O and Loewe mounts / adapters, Custom RAL paint finishes, Marine suitable version
Package Contents	Mechanism, IR remote control
Environment	Residential / Commerical
Colour	WHITE - RAL9910 Satin Finish
Marine Suitable	No - Marine Indoor and Outdoor Versions Available

# CHRST7-RES

## RESIDENTIAL CEILING HINGE RANGE

### WITH SWIVEL AND TELESCOPE

#### OPTION 1 - FIXING TO WOODEN BEAMS

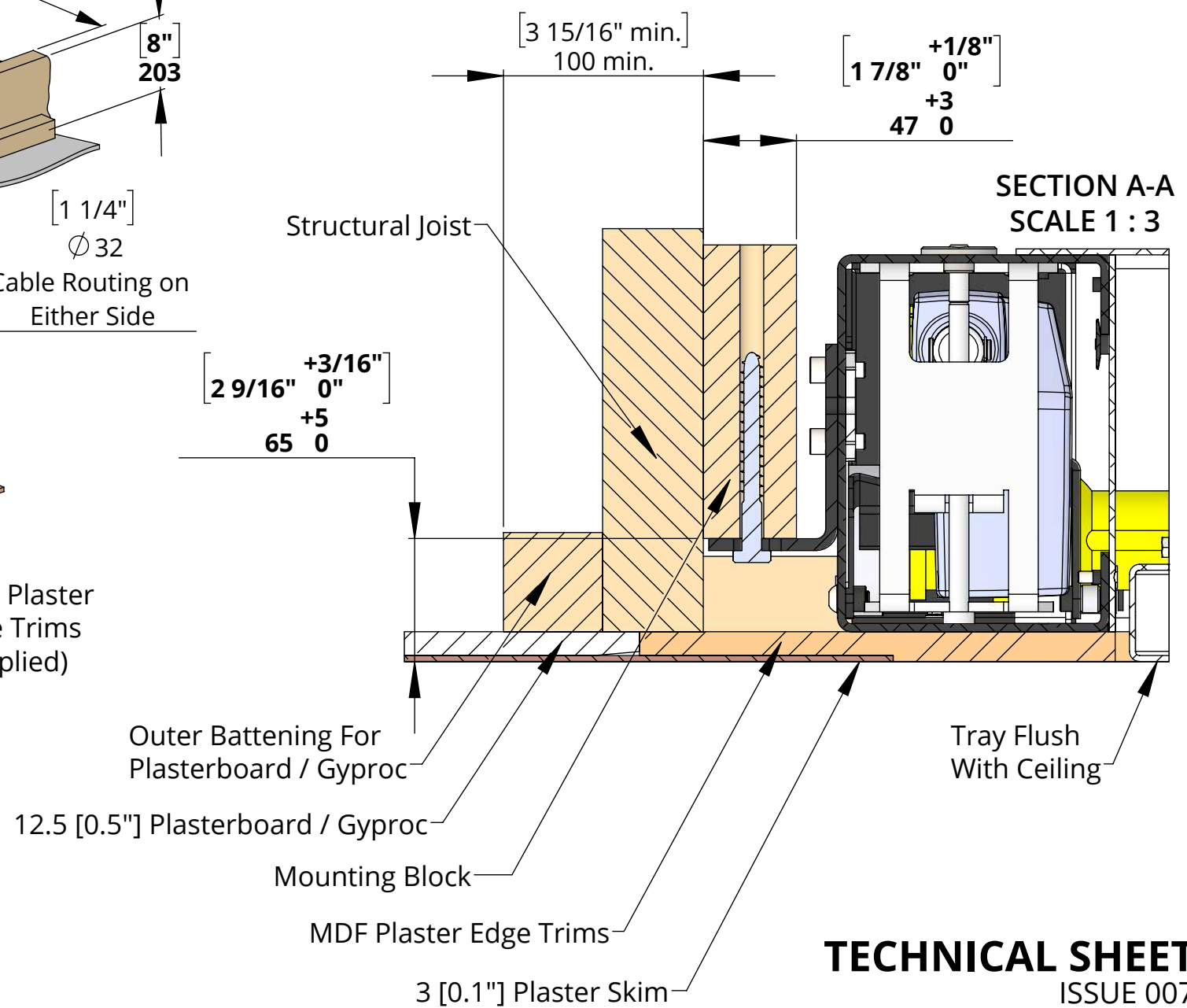
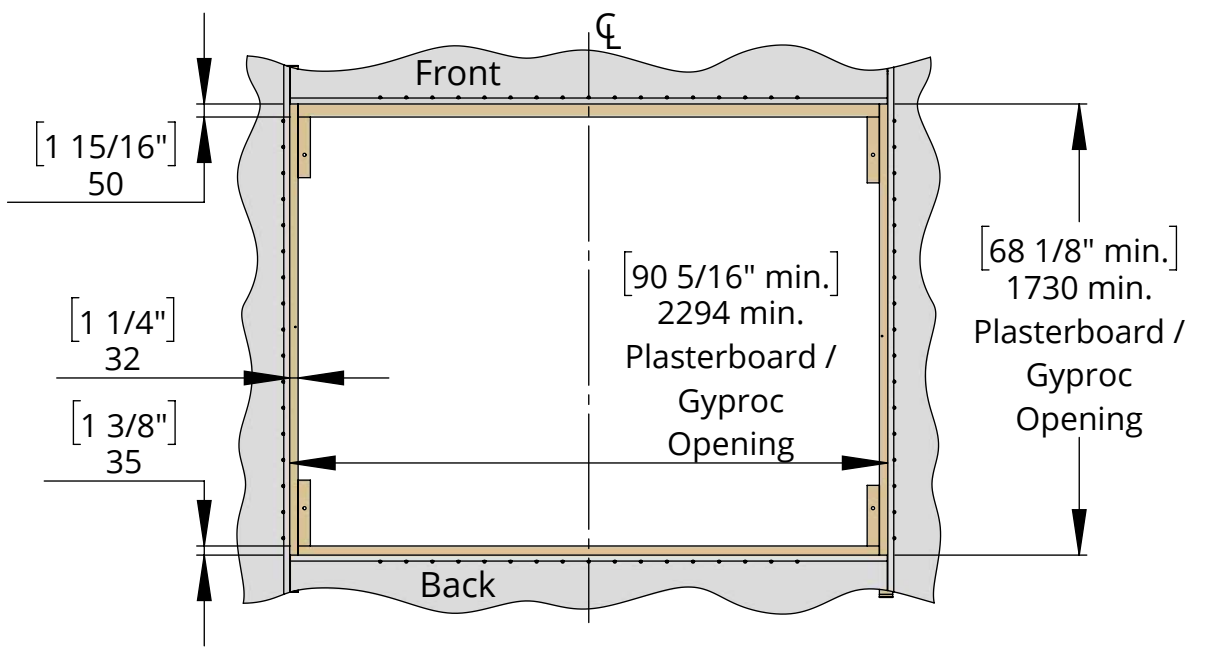
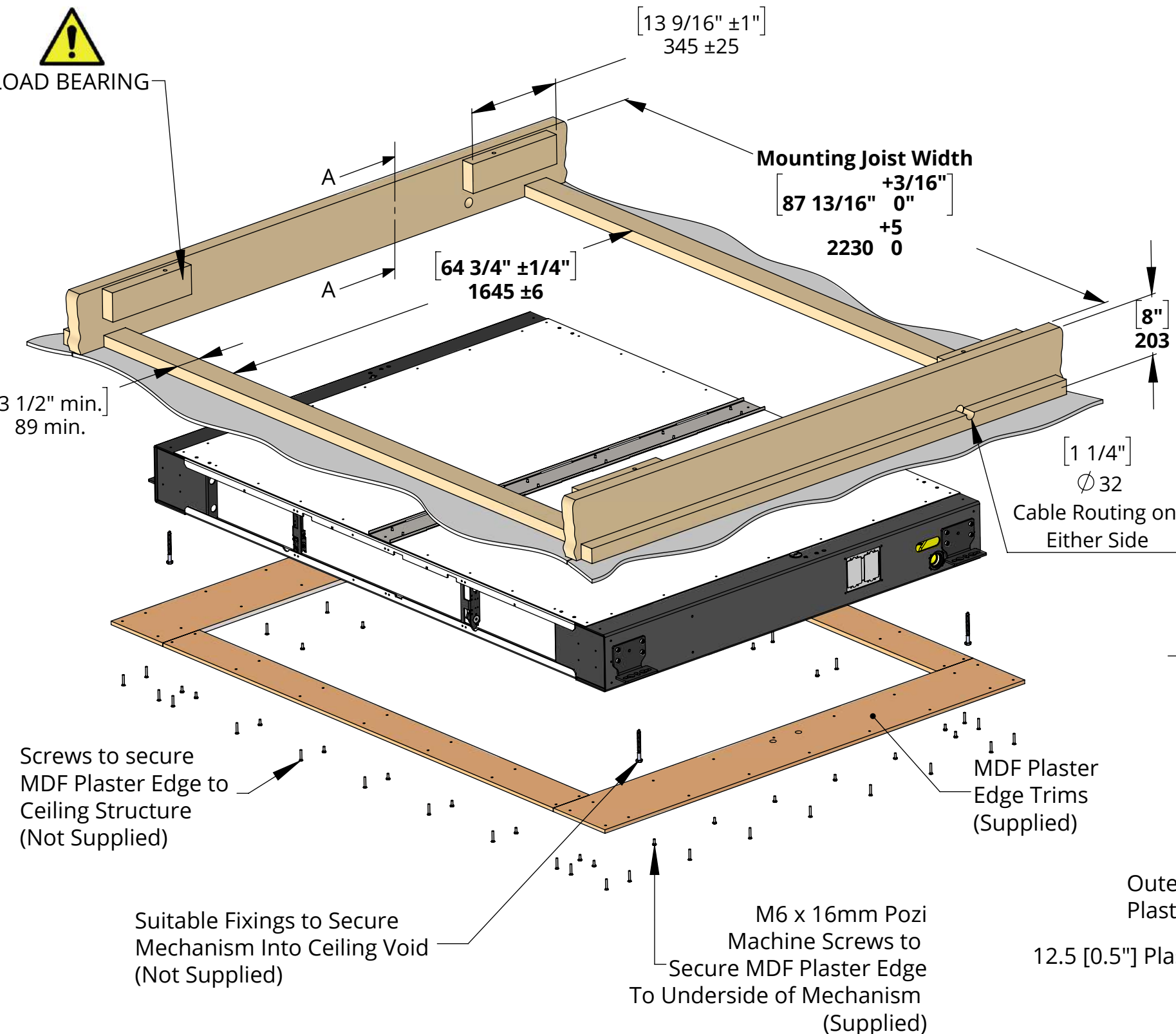

# CHRST7-RES

## RESIDENTIAL CEILING HINGE RANGE

### WITH SWIVEL AND TELESCOPE

#### OPTION 2 - FIXING INTO SUSPENDED CEILING



**LOAD BEARING**  
4 x Threaded Rods to  
Secure Mechanism  
12.5 [0.5"] Max.

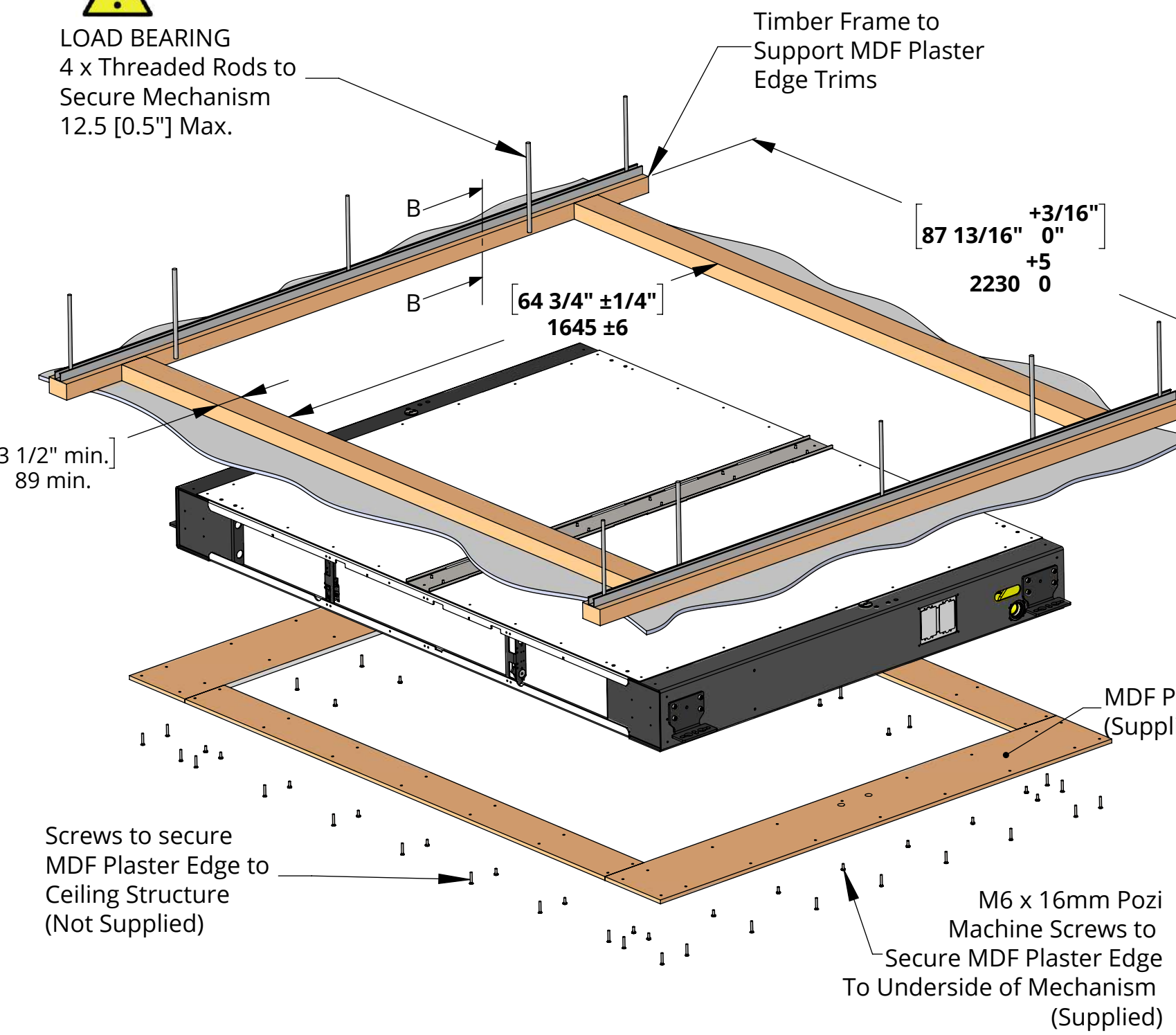

future automation

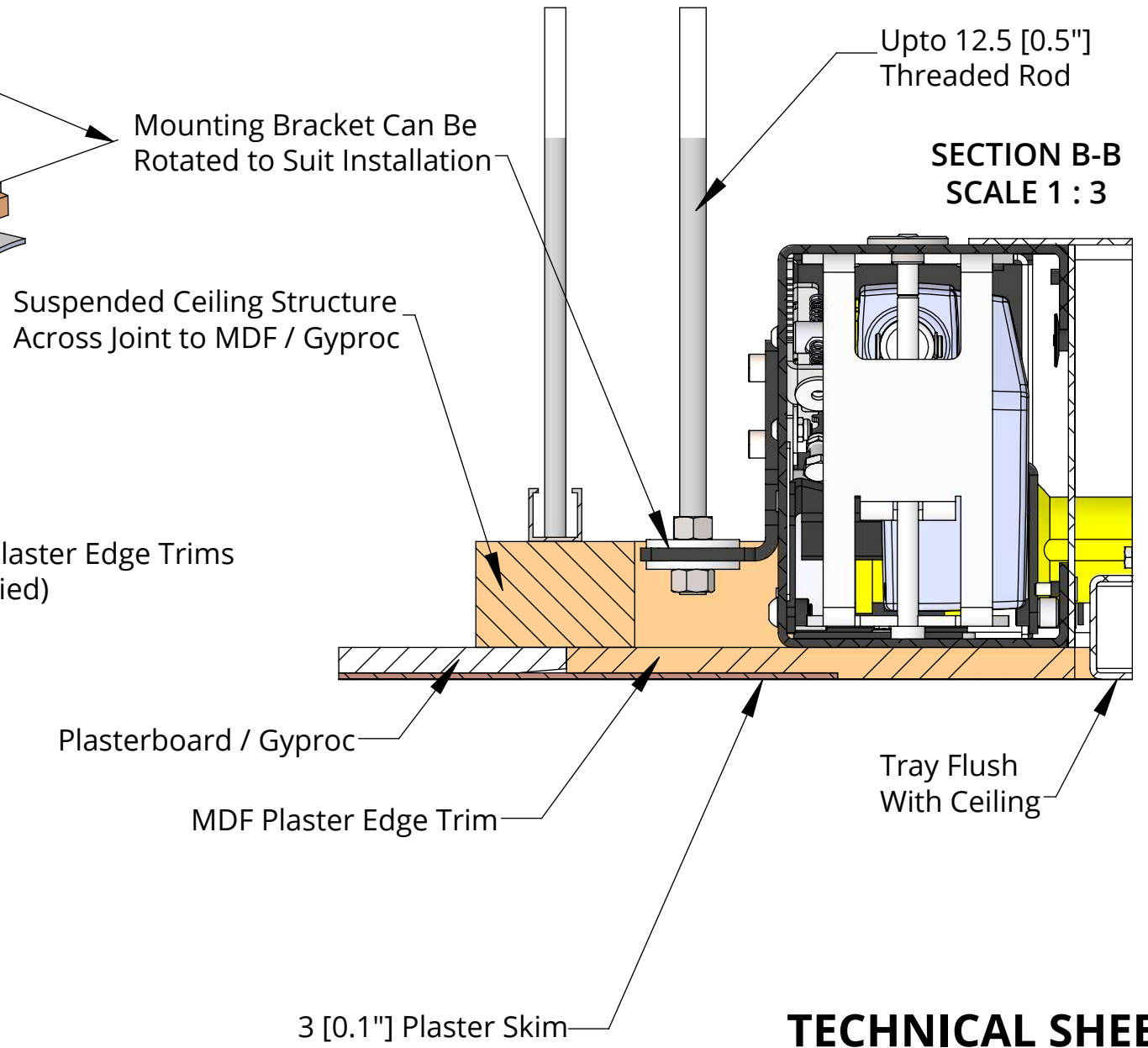
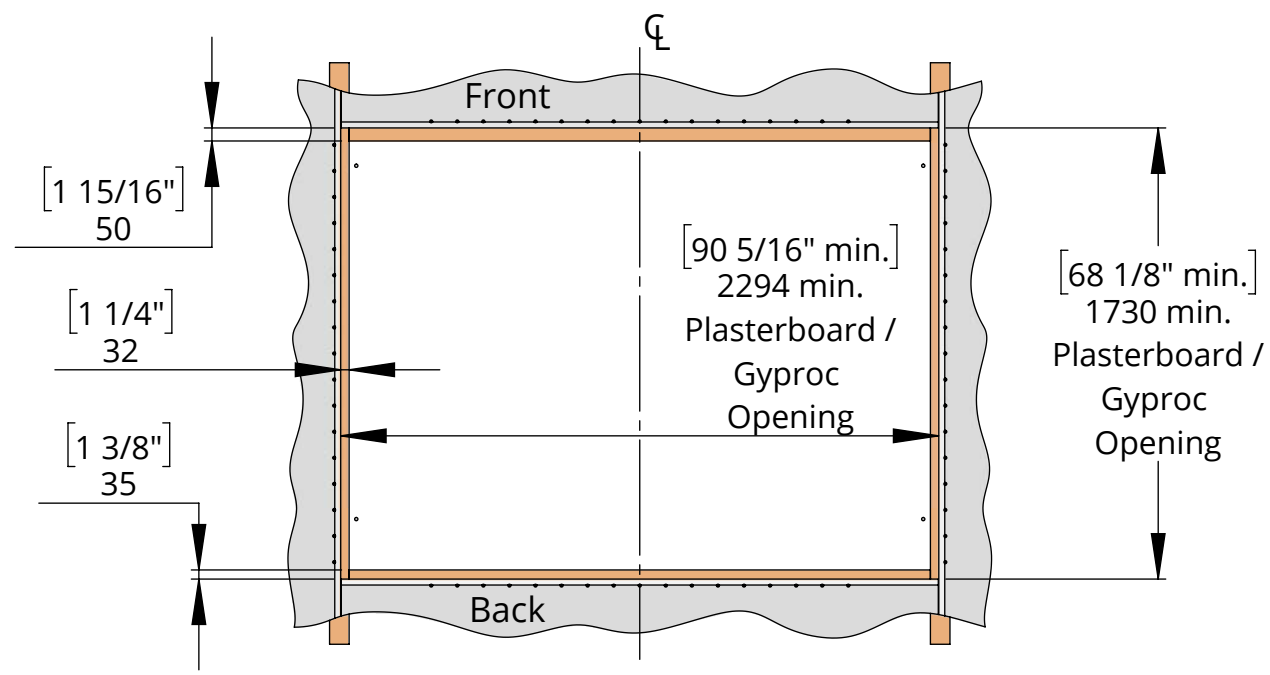

# CHRST7-RES

## RESIDENTIAL CEILING HINGE RANGE

### WITH SWIVEL AND TELESCOPE

#### INSTALLATION PRECEDURE

THE INSTALLATION PROCEDURE IS CARRIED OUT  
IN THE SAME WAY FOR OPTION 1 OR OPTION 2

#### 1. MECHANISM INSTALLATION

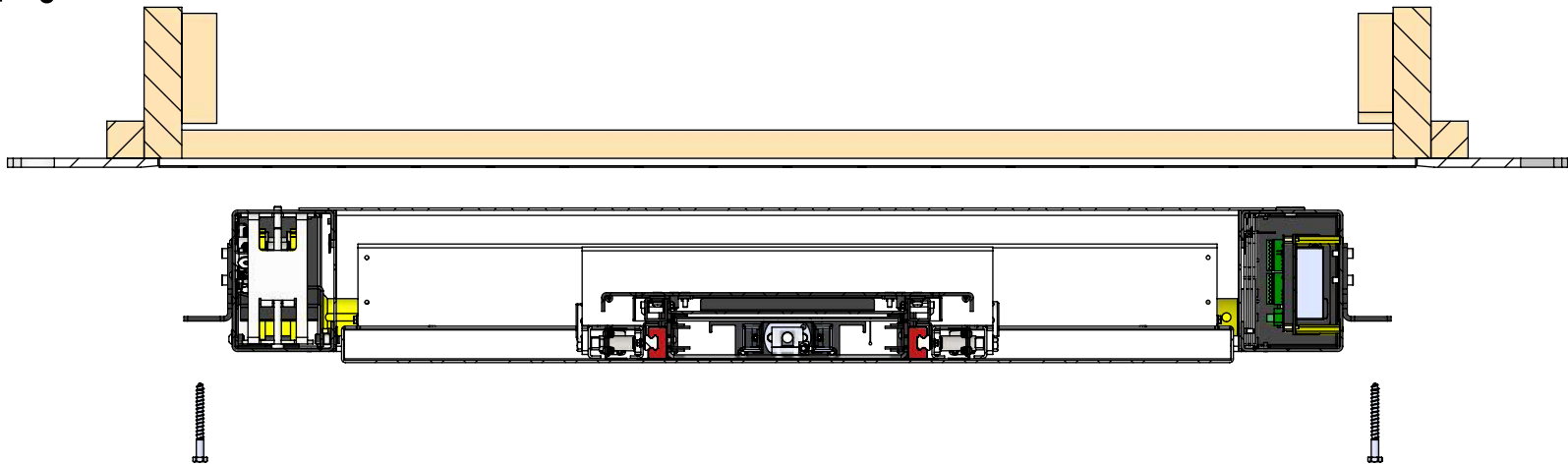

#### 2. MDF PLASTER TRIM INSTALLATION

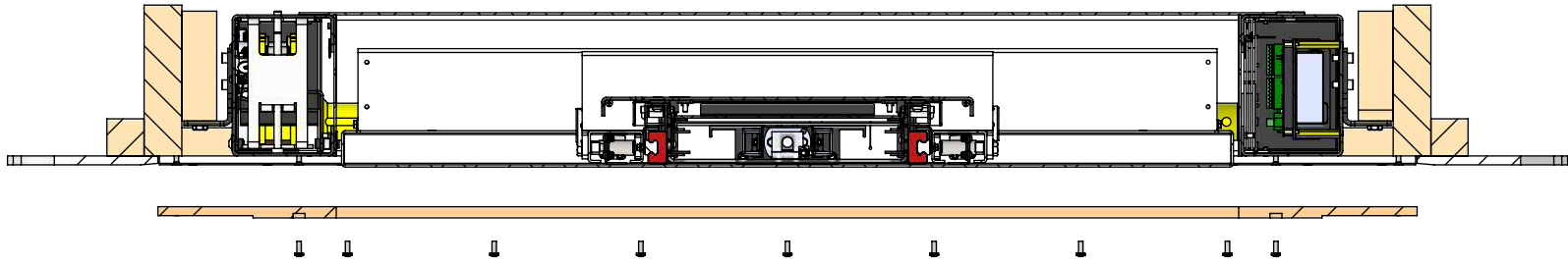

#### 3. PLASTERING

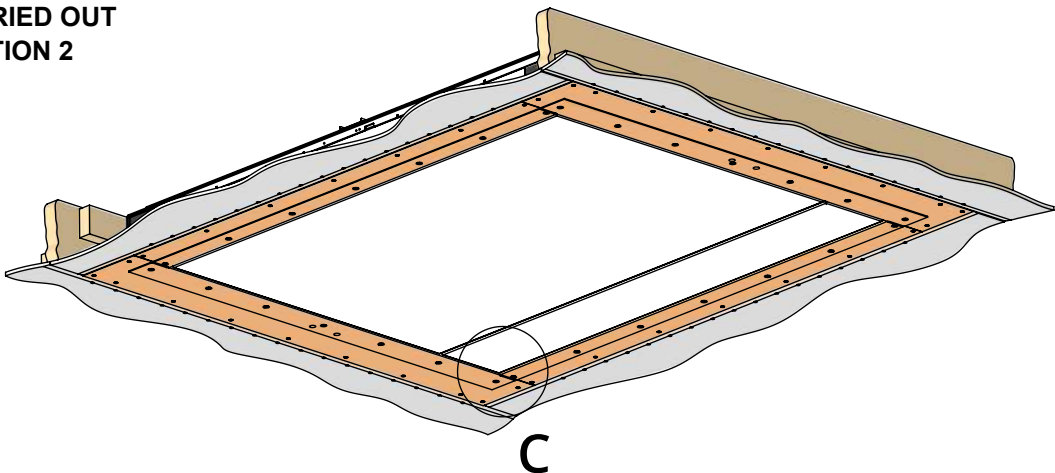
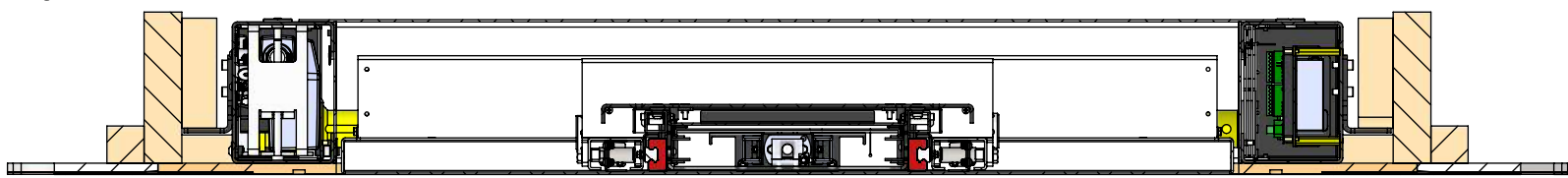

28 No. OFF  
SS M6 x 16MM  
POZI (SUPPLIED)

7mm [1/4"]  
Shadow Gap  
Around Tray

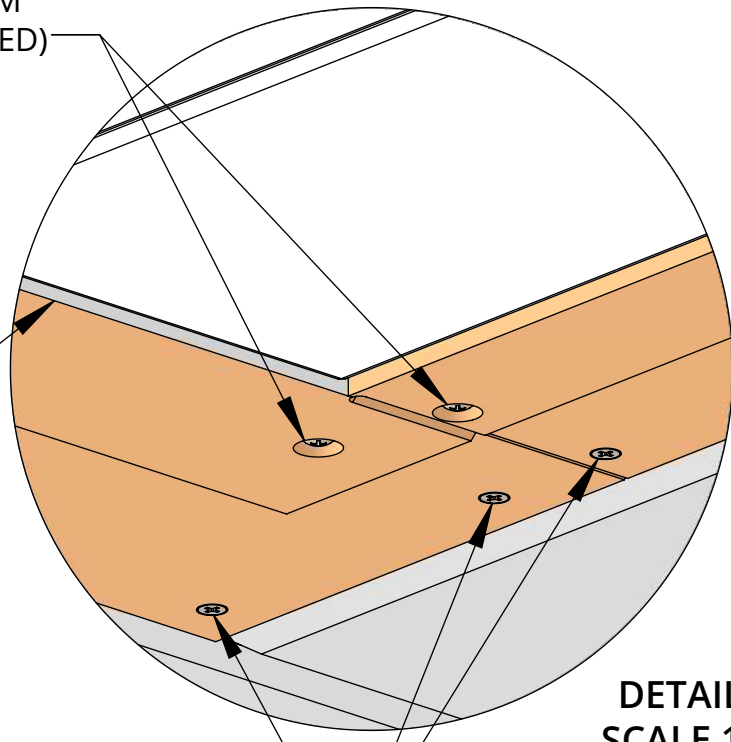

36 No.OFF  
MDF SCREW  
(NOT SUPPLIED)

DETAIL C  
SCALE 1 : 3



# CHRST7-RES

## RESIDENTIAL CEILING HINGE RANGE

### WITH SWIVEL AND TELESCOPE

### MECHANISM DIMENSIONS - CLOSED

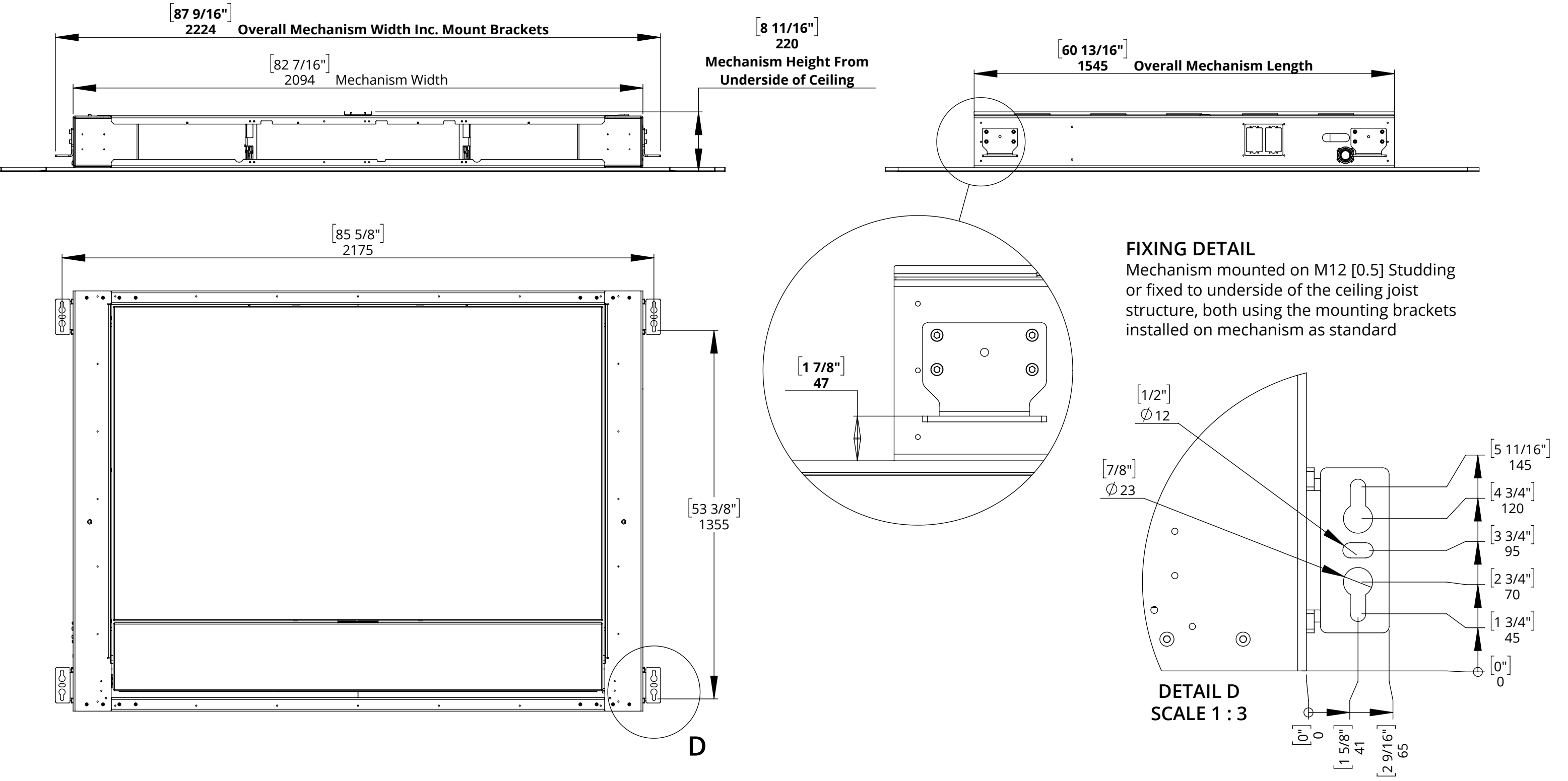

# CHRST7-RES

## RESIDENTIAL CEILING HINGE RANGE WITH SWIVEL AND TELESCOPE

### MECHANISM DIMENSIONS - OPEN

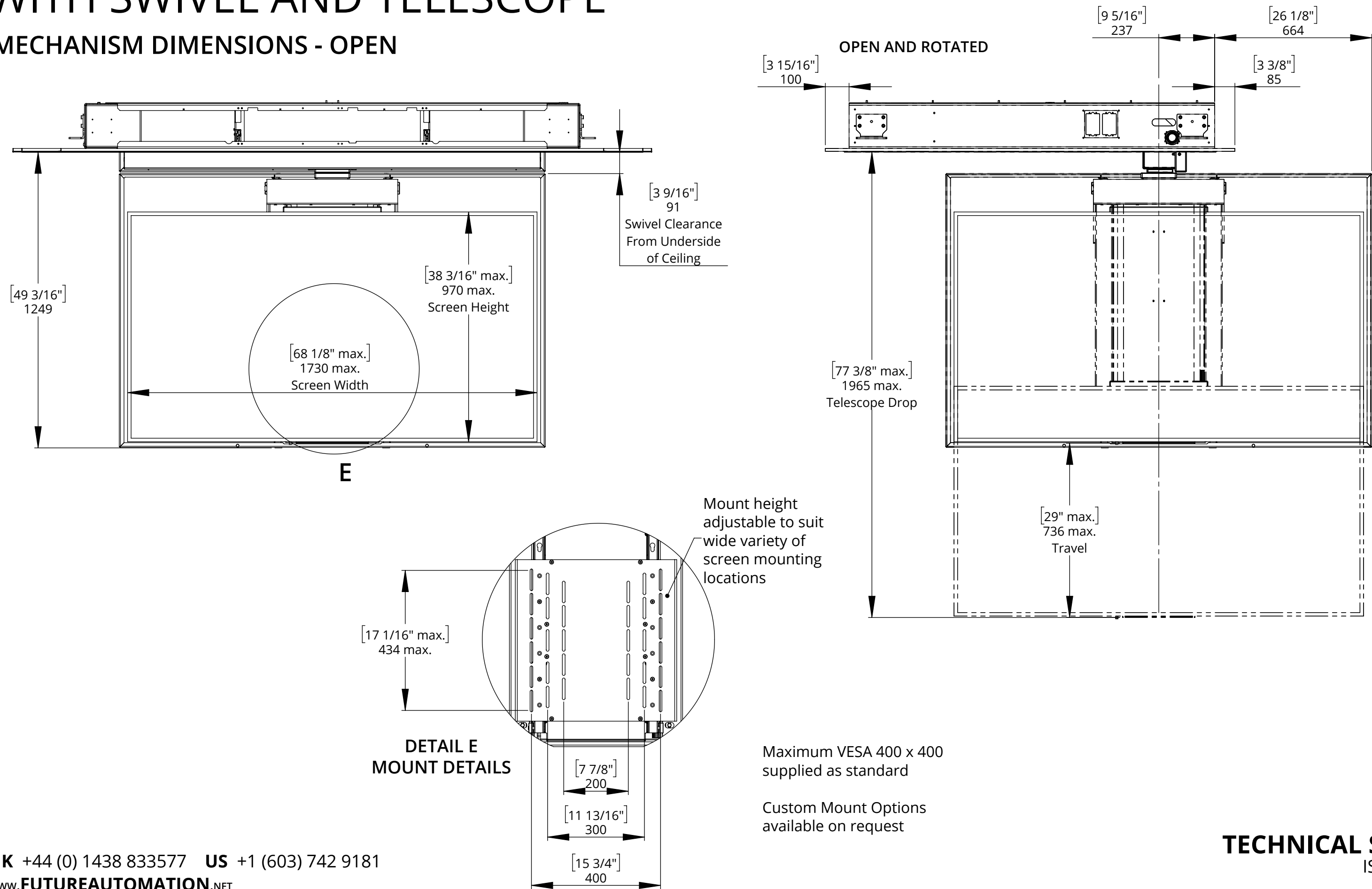

# CHRST7-RES

## RESIDENTIAL CEILING HINGE RANGE

### WITH SWIVEL AND TELESCOPE

### CEILING PREPARATION

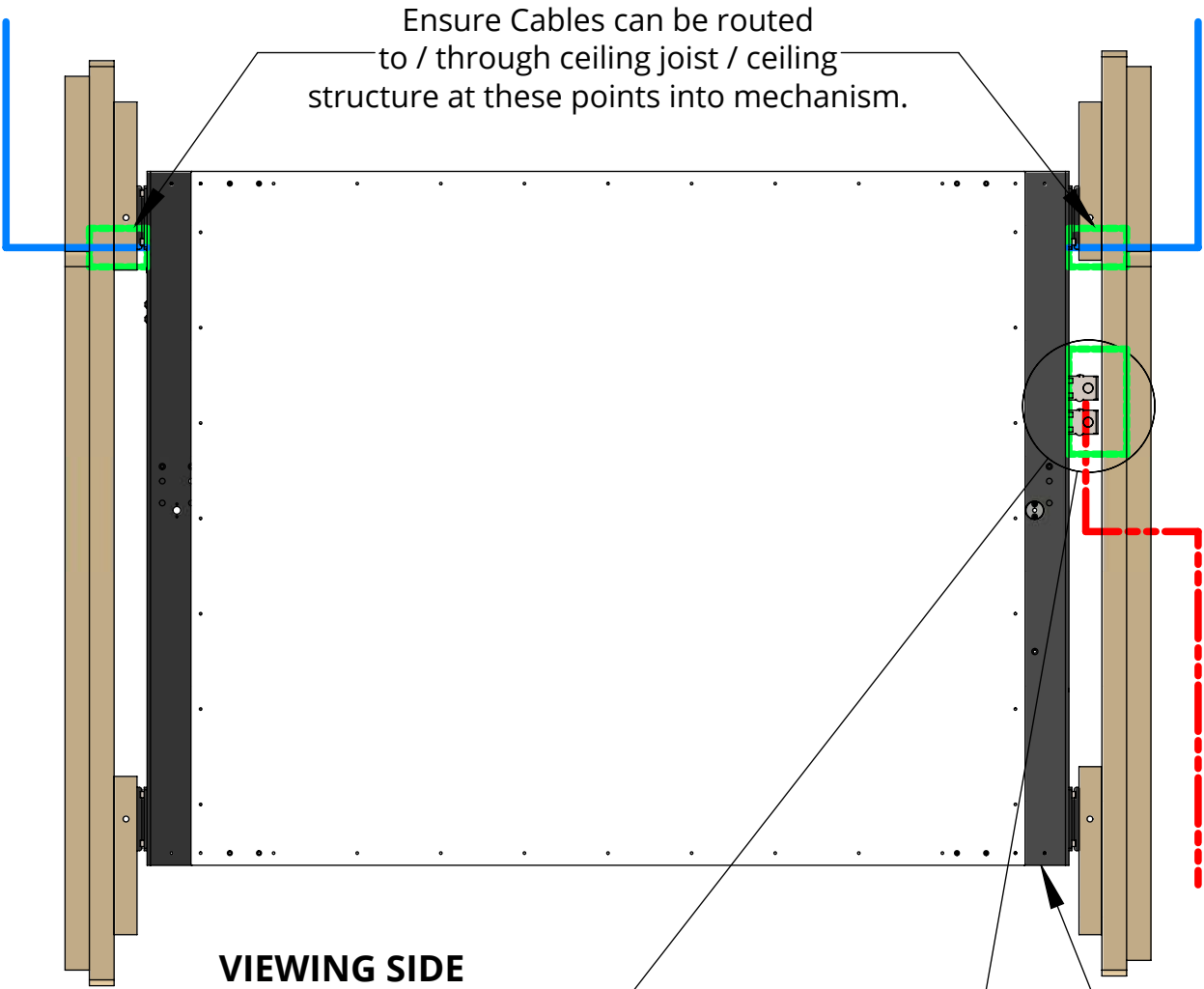

VIEWING SIDE

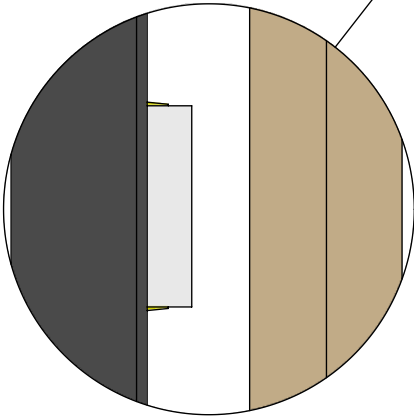

UK 2G Mains  
Plasterboard  
Back Box

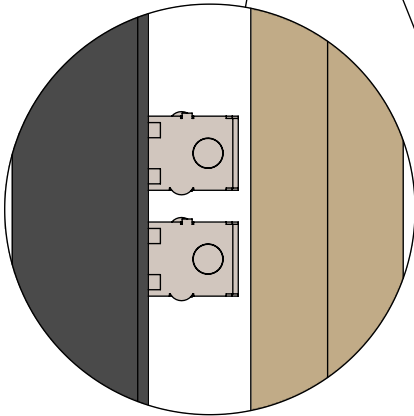

2 No.  
US J-Box

### Cable Routing

Cables for the screen can be routed in from both sides, allowing for power and signal cables to be separated when entering the mechanism.

The opening on both sides is MIN. 32mm [1.3"] in diameter allowing for multiple cables to be routed to the screen.

A power outlet mounting plate is supplied in the right hand gearbox allowing for UK and US power outlets to be wired directly into the mechanism.

Mechanism control system housed internally on this side. Accessible from removable internal access hatch.

- AV Signal Cables / Mechanism Control Cables
- - - Power Cable for Mechanism and AV

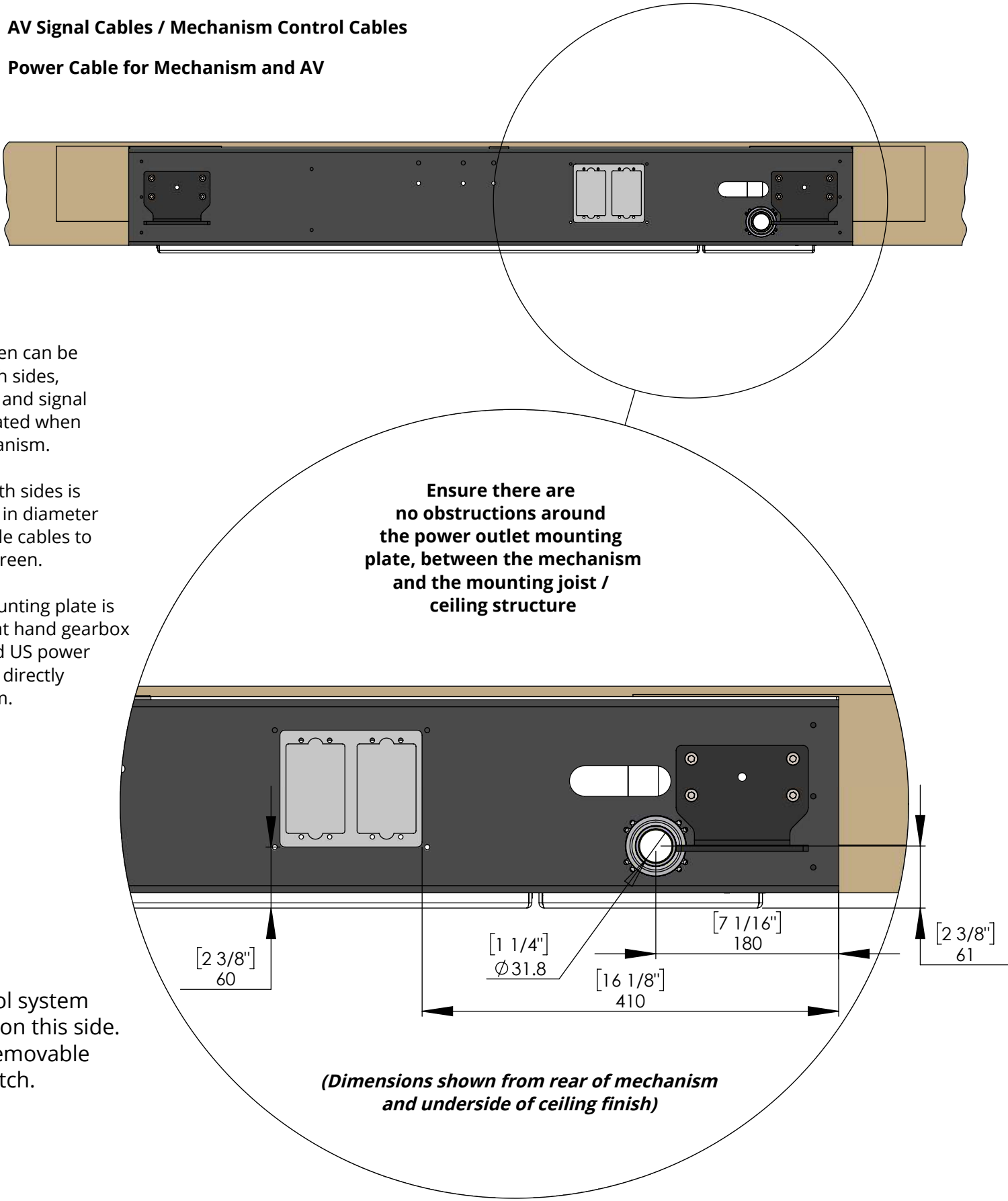

(Dimensions shown from rear of mechanism and underside of ceiling finish)